



SOUTHERNPINE

30% STRONGER THAN STANDARD PINE

INSTALLATION GUIDE FOR SOUTHERNPINE DECKING

A 'MUST READ GUIDE' BEFORE FITTING YOUR DECKING BOARDS

PINE DECKING IS BEST SUITED TO COVERED/SHELTERED DECK APPLICATIONS.

SouthernPine WBA decking is treated with water based azole to protect from fungal decay and insect attack. To protect your deck from the effects of moisture and weathering, use quality decking oil or paint.

1 LIGHTLY SAND BOARDS



Use 80 or 100 grit sandpaper

2 PRE-COAT ALL 4 SIDES & CUT ENDS



Allow oil to dry before install



AVOID DIRECT SUNLIGHT



KEEP TIMBER DRY

3 FIX BOARDS TO JOISTS

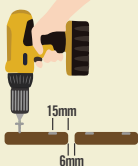

- Pre-drill holes
- Use stainless steel screws
- Stagger joints across multiple joists

4 CLEAN THE DECK



Use a soft bristled broom



DO NOT POWER WASH

5 APPLY TOP COAT OF OIL



6 ALLOW TO DRY BEFORE USE



7 DAYS

Tru-Core® WBA
H3 Treated



Australian
Made



Non
Arsenic



Termite
Resistant

All residential decks must meet the relevant building standards applicable. Baywood decking is to be installed in applications meeting the requirements of the following Data Sheets and Standards:

- Queensland Timber – Residential Timber Decks Technical Data Sheet
- Australian Standard 1684: Residential Timber – Framed Construction
- AS1720: Timber Structures – Design Methods

For further information,
please contact Baywood on
(07) 4123 3455 or visit www.baywood.com.au



BAYWOOD



SOUTHERNPINE

30% STRONGER THAN STANDARD PINE

FREQUENTLY ASKED QUESTIONS

WHY IS SOUTHERNPINE STRONGER?

The SouthernPine species is world renowned for its superior strength and stability. Grown in plantation forests throughout QLD and NSW, the higher density gives SouthernPine a natural strength advantage. Coupled with this is the fact that our decking boards are selected from the strongest part of the tree – the sapwood.

WHAT IS WBA ?

WBA is an eco-friendly water based preservative treatment. It is used to protect above-ground timber from fungal decay and termites. Unlike traditional wood treatments, WBA does not contain heavy metals or solvents, and is APVMA approved. By choosing WBA treated pine, you can enjoy the benefits of a safe, natural appearance that will stand the test of time.

WILL SOUTHERNPINE CRACK AND SPLIT?

Like all timber, SouthernPine is a natural product and is susceptible to surface checking. This is more likely if the deck is fully exposed to the weather. Applying a good quality decking oil will help minimize the effects of weathering. Re-coating regularly will re-seal any visible surface checking, marks and scratches.

WHICH DECKING OIL SHOULD I USE?

Choosing a decking oil can be quite a challenge with so many products available. For SouthernPine, there are some key things to remember:

- Avoid darker colours as they tend to heat up in the sun.
- Avoid cheap oils that form a hard, inflexible coating as they tend to crack and peel - exposing the timber.
- Avoid clear varnishes as sunlight can cause the timber to turn grey underneath the coating.

WHY DO I NEED TO COAT ALL SIDES?

Pre-coating timber decking on all 4 sides before installation is of paramount importance to prevent moisture absorption from above and below the deck. An increase in moisture content leads to excessive swelling, and rapid loss of moisture leads to twisting, cupping and splitting

HOW DO I MAINTAIN SOUTHERNPINE DECKING?

A simple clean down with a soft bristle broom will remove most dirt and debris. Avoid excessive wetting and pressure cleaners. Like any timber, SouthernPine will need re-coating to maintain optimum protection. The time-frame to reapply will vary depending on the type of exposure. Regularly monitor for signs of colour loss, dryness and weathering. Note that additional coats will result in developing a stronger colour.